

TILLAMOOK COUNTY SURVEYORS OFFICE  
COURT HOUSE, TILLAMOOK OREGON 97141

SECTION CORNER COMMON  
TO SECTIONS 24 & 25, T.3S.,R.10W.,W.M.  
AND SECTIONS 19 & 30, T.3S.,R.9W.,W.M.

T3S	
R10W	R9W
S24	S19
1958	
RS 401	

I found a 2" iron pipe with a 3" O.S.B.F. Bronze cap (see T.C.S. Map #B-841).  
I encased the found iron pipe and bronze cap in a 10" concrete cylinder.

History of found monument

This corner was erroneously set in 1958, in T.C.S. Rewitness Book 1 at page 362, and later corrected, on T.C.S. Map #B-841.

No original evidence was found nor any from Rewitness Book 10 at Page 113 or field notebook "Hayes F" at page 77.

I found this monument to be as described on T.C.S. Map #B-1045 and the accessories found and/or set at that time to now be as follows:

(B-841) 16" Spruce S.19 1/2°E. 22.3', Reported on T.C.S. Map #B-830 & B-831 as a 16" Spruce S.19 1/2°E. 23.0', scribing visible, And reported on T.C.S. Map #B-1045 as a 16" Spruce S.19 1/2°E. 23.2'; (Now a 16" Spruce S.19 1/2°E. 22.3', face healed over, U.S.F.S. yellow metal location poster attached).

(B-841) 17" Hemlock S.34 1/2°W. 21.9', Reported on T.C.S. Map #B-830 & B-831 as a 17" Hemlock S.34 1/2°W. 22.6', scribing visible, And reported on T.C.S. Map #B-1045 as a 17" Hemlock S.34 1/2°W. 22.5'; (Now a 23" Hemlock S.34 1/2°W. 21.9', face healed over, U.S.F.S. yellow metal location poster attached).

(B-841) 16" Spruce N.86°W. 22.7', Reported on T.C.S. Map #B-830 & B-831 as a 16" Spruce N.86°W. 23.4', scribing visible, And reported on T.C.S. Map #B-1045 as a 16" Spruce N.86°W. 23.6'; (Now a 18" Spruce N.86°W. 22.7', face healed over, U.S.F.S. yellow metal location poster attached).

(B-841) 13" Spruce N.70°E. 70.3', Reported on T.C.S. Map #B-830 & B-831 as a 13" Spruce S.70°E. 70.8', scribing visible, And reported on T.C.S. Map #B-1045 as a 13" Spruce N.64°E. 70.7'; (Now a 14" Spruce N.64°E. 70.3', face healed over, U.S.F.S. yellow metal location poster attached).

(B-841) 5/8" iron rod set at place of erroneous corner N.58°12'E. 60.56'; (Found at position).

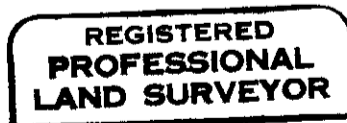
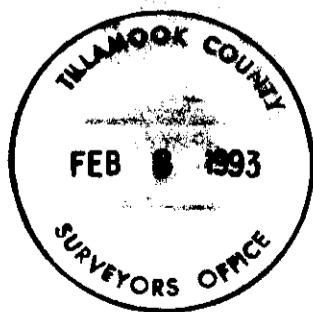

*Allan E. Dungan, C.S.*

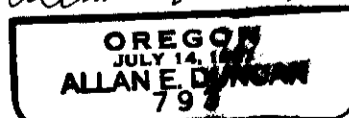

*EXPIRES 12-31-93*

PAGE 1 OF 2

**New Accessory**

\*72" light hat section post North 1.5'.

\*indicates Tillamook County Surveyors yellow metal location poster attached.

---

**Surveys and Rewitnesses of Record**

Field notebook Hayes "F" Page 77 and Book 1 Page 5	July 1887	R.R. Hayes C.S.
B-505	erroneous corner position	
B-363	erroneous corner position	
B-511	erroneous corner position	
B-841	5-10-79	Richard A. Morris RS 401 Harold J. Russell RS 707
B-1045	January 1982	Edgar R. Cook LS 1073
B-830	3-13-79	Larry D. Bishop LS 896
B-831	3-13-79	Larry D. Bishop LS 896
A-1291	erroneous corner position	
A-1430	erroneous corner position	
A-2020	erroneous corner position	
A-668	erroneous corner position	
Rewitness Card #522	erroneous corner position	
Book 10 Page 113	approximately 1893	
Survey Book S3 Page 232	4-25-1899	A.M. Austin
Rewitness Book 3 pages 336 & 337	erroneous corner position	
Rewitness Book 1 Page 362	erroneous corner position	

---

**Monument Location**

This Monument is located in a swampy area, N.10°W 45' from where a large creek flows over solid rock and falls about 2' in elevation. The NE bearing tree is 17' swesterly of an old logging road.

---

In the presence of Dan McNutt and Al Dvorak

December 10, 1992

Title:



*Allan E. Duncan, C.S.*

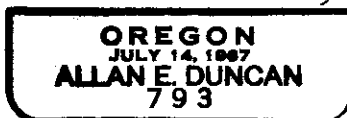

*EXPIRES 12-31-93*

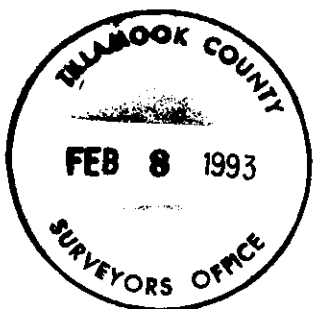

PAGE 2 OF 2